

# Preparing samples for dispatch to Biomnis

1

- Check the preanalytical conditions against the test guide for the relevant laboratory test at [www.biomnis.com/international](http://www.biomnis.com/international)
- Send **one tube** per test
- Decant the plasma and serum samples
- For tests over several days (e.g., faeces), send all samples together in one shipment.
- Send sufficient quantities for measurement of all of the requested parameters.

2



Ensure bottles of urine are properly closed

3



- Last name + first name + sex of the patient
- Date of birth
- Date of sampling

Ensure patient details are exactly the same on the sample and order form.

4



- Fill out the **test order form** and remember to include your **client identification details**.
- Always specify:
  - The **date and time** of sampling
  - Any **clinical details** needed to interpret the results (specific sheets are available for certain tests, see test guide)
  - Attach regulatory documents (patient's informed consent form), if applicable

## 5 TYPES OF BAG



AMBIENT FROZEN REFRIGERATED ANATOMICAL PATHOLOGY MYCOBACTERIA

5

1 bag = 1 patient = 1 temperature



6



Place the sample in the main airtight pocket

7

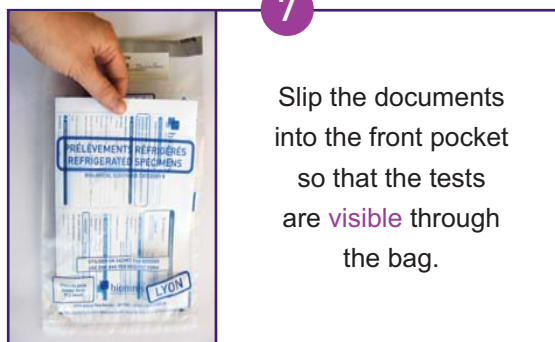

Slip the documents into the front pocket so that the tests are **visible** through the bag.

8



Peel off the silver strip and seal both pockets



Full information and all documents relating to the tests offered by Biomnis can be found in the test guide for the respective test at: [www.biomnis.com/international](http://www.biomnis.com/international)

**CONTACT**  
[international@biomnis.com](mailto:international@biomnis.com)